

PrevaLED Core G7 Food

Spot-, Down- and Wallmount Light Engines and Modules



Product family features

- Complete portfolio with varying luminous flux, color temperature, color rendering
- LED module is basic isolated to mounting surface
- Photobiological safety according to IEC/TR 62778, risk group RG1
- Max. working voltage: 60 V (to be operated only on SELV LED control gear)

Product family benefits

- Easy integration thanks to very compact form factor
- Easy cooling due to optimized efficiency and high maximum operation temperature
- High driver flexibility allows cost-effective and intelligent systems
- 5 year guarantee

Areas of application

- Excellent light for FOOD applications
- Spotlighting in shops and retail
- Down- and wall lighting in offices, corridors, meeting rooms, workplaces
- Decorative and functional lighting in hospitality, hotels, restaurants
- Functional lighting in public and commercial buildings



Product family datasheet

Technical data

Product description	Electrical data			Photometrical data		Light technical data	
	Nominal voltage	Type of current	Nominal current	Luminous efficacy	Color rendering index Ra	Starting time	Warm-up time (60 %)
PL-CORE-G7 3000-S35 L15 H1 ¹⁾	350 V	DC	078 A	110 lm/W	80	00 s	000 s
PL-CORE-G7 3000-S65 L15 H1 ¹⁾	348 V	DC	055 A	158 lm/W	80	00 s	000 s
PL-CORE-G7 2000-S65 L15 H1 ¹⁾	341 V	DC	035 A	168 lm/W	80	00 s	000 s
PL-CORE-G7 3000-S40 L15 H1 ¹⁾	360 V	DC	133 A	63 lm/W		00 s	000 s

Product description	Beam angle	Dimensions & weight			
		Product weight	Length	Width	Height
PL-CORE-G7 3000-S35 L15 H1 ¹⁾	11460 °	600 g	44.0 mm	44.0 mm	3.0 mm
PL-CORE-G7 3000-S65 L15 H1 ¹⁾	11460 °	600 g	44.0 mm	44.0 mm	3.0 mm
PL-CORE-G7 2000-S65 L15 H1 ¹⁾	11460 °	600 g	44.0 mm	44.0 mm	3.0 mm
PL-CORE-G7 3000-S40 L15 H1 ¹⁾	11460 °	600 g			

Product description	Temperatures & operating conditions			
	Performance temp. acc. to IEC 62717	Maximum temperature at tc test point	Ambient temperature range	Temperature range at storage
PL-CORE-G7 3000-S35 L15 H1 ¹⁾	65 °C	100 °C	-20...+50 °C	-20...60 °C
PL-CORE-G7 3000-S65 L15 H1 ¹⁾	65 °C	100 °C	-20...+50 °C	-20...60 °C
PL-CORE-G7 2000-S65 L15 H1 ¹⁾	65 °C	100 °C	-20...+50 °C	-20...60 °C
PL-CORE-G7 3000-S40 L15 H1 ¹⁾	65 °C	100 °C	-20...+50 °C	-20...60 °C

Product description	Lifespan		Additional product data	Certificates & standards
	Number of switching cycles	L70B50 lifetime	Lighting technology used	Standards
PL-CORE-G7 3000-S35 L15 H1 ¹⁾	100000	60000 h	LED	CE/ENEC
PL-CORE-G7 3000-S65 L15 H1 ¹⁾	100000	60000 h	LED	CE/ENEC
PL-CORE-G7 2000-S65 L15 H1 ¹⁾	100000	60000 h	LED	CE/ENEC
PL-CORE-G7 3000-S40 L15 H1 ¹⁾	100000			CE/ENEC

Product description	Logistical data		Environmental information	
			Information according Art. 33 of EU Regulation (EC) 1907/2006 (RECh)	
Product description	Commodity code	Date of Declaration	Primary Article Identifier	Candidate List Substance 1
PL-CORE-G7 3000-S35 L15 H1 ¹⁾	85414100000	30-03-2023	4052899576582	No declarable substances contained
PL-CORE-G7 3000-S65 L15 H1 ¹⁾	85414100000	30-03-2023	4052899576667	No declarable substances contained
PL-CORE-G7 2000-S65 L15 H1 ¹⁾	85414100000	30-03-2023	4052899576629	No declarable substances contained

Product family datasheet

	Logistical data	Environmental information Information according Art. 33 of EU Regulation (EC) 1907/2006 (REACH)		
Product description	Commodity code	Date of Declaration	Primary Article Identifier	Candidate List Substance 1
PL-CORE-G7 3000-S40 L15 H1 ¹⁾	85414100000	02-11-2022	4052899576568	No declarable substances contained

Product description	Declaration No. in SCIP database
PL-CORE-G7 3000-S35 L15 H1 ¹⁾	No declarable substances contained
PL-CORE-G7 3000-S65 L15 H1 ¹⁾	No declarable substances contained
PL-CORE-G7 2000-S65 L15 H1 ¹⁾	No declarable substances contained
PL-CORE-G7 3000-S40 L15 H1 ¹⁾	No declarable substances contained

¹⁾ Modules perfectly matched to OSRAM OPTOTRONIC LED drivers (see relevant table)/For current photometric data and important safety, installation and application information (see www.osram.com/led-systems)./All the technical parameters apply to the entire module. In view of the complex manufacturing process for light emitting diodes, the typical values given above for the technical LED parameters are merely statistical values that do not necessarily correspond to the actual technical parameters of an individual product; individual products may vary from the typical values/Tolerance for optical and electrical data: +/-10%/OSRAM is not liable for errors in luminaires design and assembly

Product family datasheet

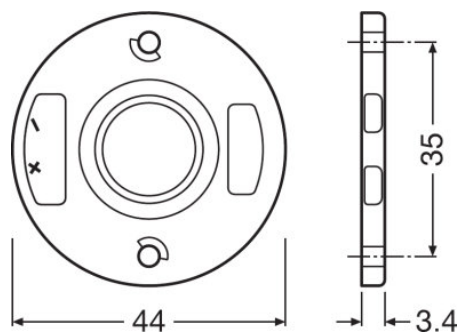

PL-CORE-G7 3000



Application advice

For more detailed application information and graphics please see product datasheet.

Sales and Technical Support

Sales and Technical Support www.osram.com

Download Data

File	
	Addon Technical Information PrevaLED Core G7 Overview
	Certificates ENEC Certificate PL CORE G7

Ecodesign regulation information:

Separate control gear and light sources must be disposed of at certified disposal companies in accordance with Directive 2012/19/EU (WEEE) in the EU and with Waste Electrical and Electronic Equipment (WEEE) Regulations 2013 in the UK. For this purpose, collection points for recycling centres and take-back systems (CRSO) are available from retailers or private disposal companies, which accept separate control gear and light sources free of charge. In this way, raw materials are conserved and materials are recycled.

Product family datasheet

Logistical Data

Product code	Product description	Packaging unit (Pieces/Unit)	Dimensions (length x width x height)	Volume	Gross weight
4052899576582	PL-CORE-G7 3000-S35 L15 H1	Shipping carton box 40	375 mm x 263 mm x 38 mm	3.75 dm ³	807.00 g
4052899576667	PL-CORE-G7 3000-S65 L15 H1	Shipping carton box 40	375 mm x 263 mm x 38 mm	3.75 dm ³	807.00 g
4052899576629	PL-CORE-G7 2000-S65 L15 H1	Shipping carton box 40	375 mm x 263 mm x 38 mm	3.75 dm ³	807.00 g
4052899576568	PL-CORE-G7 3000-S40 L15 H1	Shipping carton box 40	375 mm x 263 mm x 38 mm	3.75 dm ³	807.00 g

The mentioned product code describes the smallest quantity unit which can be ordered. One shipping unit can contain one or more single products. When placing an order, for the quantity please enter single or multiples of a shipping unit.

References / Links

For Guarantee see <https://www.inventronics-light.com/multilevel-guarantees>

Disclaimer

Subject to change without notice. Errors and omission excepted. Always make sure to use the most recent release.